

WORK ORDERED BY:
JEFFREY BASSETT
520 SALCEDA DRIVE
MUNDELEIN, IL. 60060

FARRIS, HANSEN & ASSOCIATES, INC.
ENGINEERING - ARCHITECTURE - SURVEYING
7 RIDGWAY COURT P.O. BOX 437
ELKHORN, WISCONSIN 53121
OFFICE: (262) 723-2098 FAX: (262) 723-5886

REVISIONS
7/30/2014-KB
ADD BOUNDARY
& PROPOSED
GARAGE/ADD.
5-29-2015
ADD PROPOSED
DECK &
PORCH

PROJECT NO.
8692
DATE:
10-24-2012
SHEET NO.
1 OF 1

PLAT OF SURVEY
LOT 112
2nd ADDITION TO BUBBLING SPRINGS
LOCATED IN THE SE 1/4 OF THE NE 1/4
SECTION 34, TOWN 4 NORTH, RANGE 16 EAST
WALWORTH COUNTY, WI.

- LEGEND
- = FOUND IRON PIPE STAKE
 - = FOUND IRON REBAR STAKE
 - △ = SET LS SPIKE
 - (XXX) = RECORDED AS

NOTE: COPIES OF THIS MAP TO WHICH THE FOLLOWING CERTIFICATE
WILL APPLY SHOW THE SURVEYOR'S ORIGINAL SEAL AND SIGNATURE
IN RED INK. COPIES BY ANY OTHER MEANS MAY HAVE ALTERATIONS
WHICH DO NOT REPRESENT THE SURVEYOR'S WORK PRODUCT.

I HEREBY CERTIFY THAT THE ABOVE DESCRIBED PROPERTY HAS BEEN
SURVEYED UNDER MY DIRECTION AND THAT THE ABOVE MAP IS A TRUE
REPRESENTATION THEREOF AND SHOWS THE SIZE AND LOCATION OF
THE PROPERTY AND ITS EXTERIOR BOUNDARIES. THIS SURVEY IS
MADE FOR THE USE OF THE PRESENT OWNERS OF THE PROPERTY, AND
ALSO THOSE WHO PURCHASE, MORTGAGE, OR GUARANTEE THE TITLE
THERE TO WITHIN ONE YEAR FROM THE DATE HEREOF.

DATED: JUNE 3, 2015

Peter S. Gordon
PETER S. GORDON P.L.S. 2101

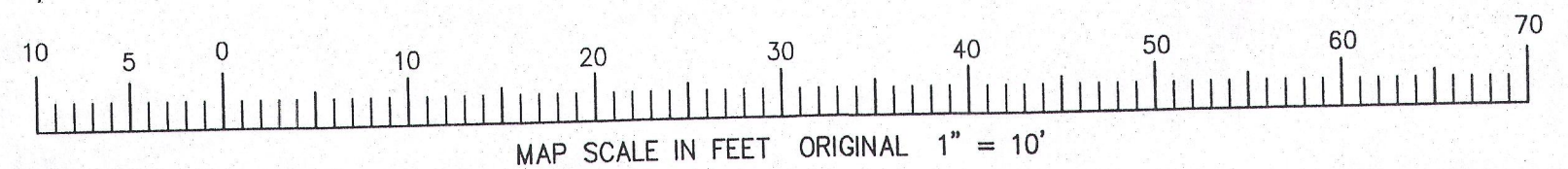
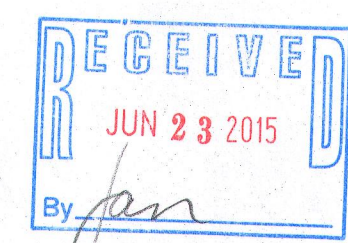
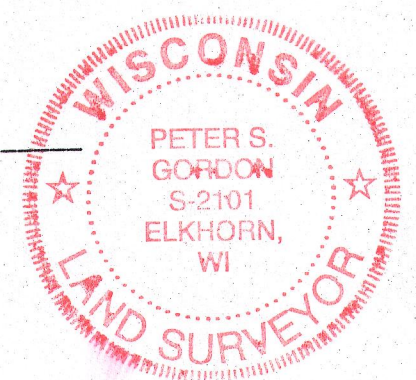

HB82 -33 416-2786

ASSIGNED SW LINE LOT 112
N 25°26'07" W

MIDDLE LAKE
LAKE EL. = 884.5'
80' +/- ALONG THE SHORE

TAX PARCEL HBS2-00033

WALL TERRACES INSTALLED
TO REPLACE DETERIORATED
TIMBER WALLS

PROPOSED MATCHING BLOCK
TO REPLACE WOOD RETAINMENT
WALL THAT IS DETERIORATED
(SAME LOCATION & GRADE
UNDER LOWER DECK)

AS BUILT
GARAGE

EXISTING
RESIDENCE

NORTH DRIVE
66' WIDE R.O.W.3